



127 Shepherds Hill Road Eden Hills SA

3 1 3

Offering plenty of potential this solid 1950's stone fronted 3 bedroom home is situated on a huge 935m2 allotment – either move in, rent out, renovate or redevelop (STCC) the choice is yours!

Comprising of living and dining to the front of the home with split system RC/AC, high ceilings and polished timber flooring. Functional kitchen with under bench oven, gas cook top and dishwasher. 3 spacious bedrooms all with built-in robes and ceiling fans. Study/retreat adjacent to bedroom 3. This space would make a great home office or teenager retreat. For that extra added floorspace there is a decent sized light filled sunroom to the rear of the property. The bathroom incorporates a deep bath and there is a separate toilet. The large undercover paved pergola area is a terrific space for entertaining and also features an above ground pool all within the massive back yard. Perfect for

Building Size : 259 sqm
Land Size : 935 sqm
View : <https://www.taplin.com.au/sale/sa/south-south-east-suburbs/eden-hills/residential/house/6100796>



Heath Lapthorne
08 8295 4104

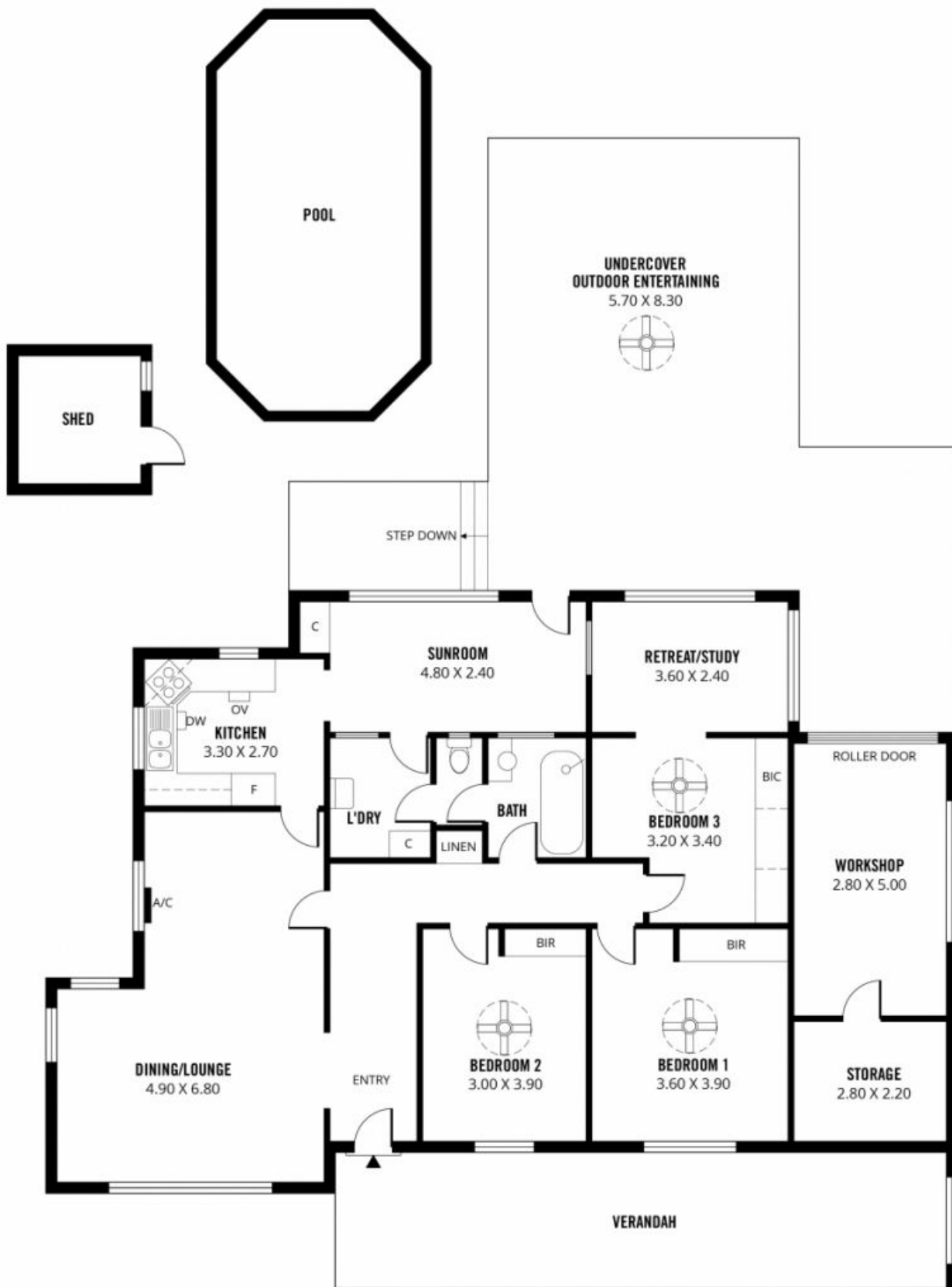

259m²
TOTAL

154m²
Living

7m²
Shed

28m²
Verandah

70m²
Outdoor Entertaining

TAPLIN



Scale in metres. This drawing is for illustration purposes only. All measurements are approximate and details intended to be relied upon should be independently verified.

Produced by **The Fotobase Group**